

D series touch panel



D1



1. Technical Specs:

- Input Voltage: DC12V-24V
- Load Current: 4A×3CH Max 12A
- Grey Scale Level: 4096
- Dimming Range: 5%-100%
- Max Output Power: 144W/288W(12V/24V)

- Working Temperature: -20°C~60°C
- Dimensions: L86×W86×H36(mm)
- Package Size: L113×W112×H50(mm)
- Weight(G.W.): 208g

2. Installation Instruction:

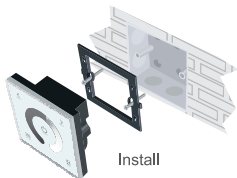

1

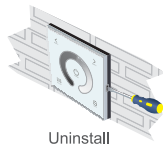

Uninstall

3. Key Functions:



* Long press to turn on/off the tone.

4. Green Block:

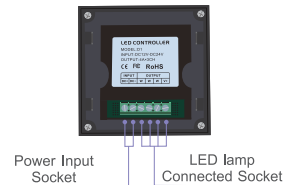

5. Wiring Diagram:

E.g 1: Connect with 12V Strip. Max 48W/CH(12V)
AC220V/110V

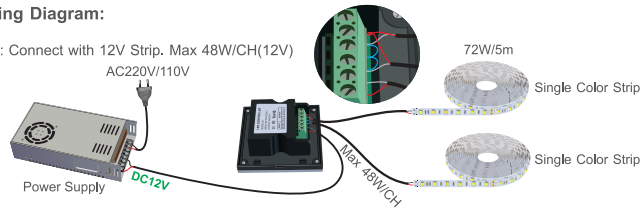

E.g 2: Connect with 24V Strip. Max 96W/CH(24V)

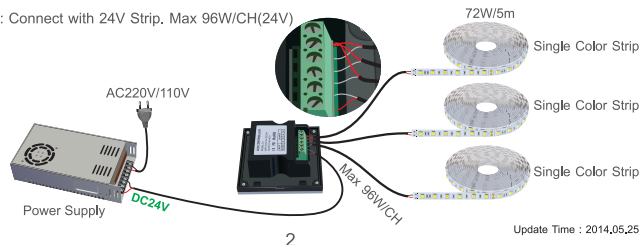

2

Update Time : 2014,05,25